

THIS DRAWING IS UNPUBLISHED. RELEASED FOR PUBLICATION 20
 © COPYRIGHT 20 BY - ALL RIGHTS RESERVED.

REVISIONS					
P	LTR	DESCRIPTION	DATE	DWN	APVD
	A	FIRST VERSION	18OCT2018	G.F	S.M

NOTES :

MATERIALS AND FINISH:
 - HOUSING: HIGH TEMPERATURE RESIN
 - CONTACTS: COPPER ALLOY, FINISH: PRE-TIN OVER NICKEL UNDERPLATE

- MUST COMPLY WITH DIRECTIVE 2002/95/EC (ROHS)
- WIRE TYPES AND SIZES ACCEPTED
 SOLID WIRE: 18AWG, 20AWG, 22AWG, 16AWG (ONLY ONE TIME INSERTING)
 STRANDED WIRE(TIN-DIPPED): 18AWG(STRANDS:16); 20AWG(STRANDS:7);
 22AWG(STRANDS:7)
 MAX INSULATION OD: 2.05mm MAX.
 STRIP LENGTH: 8.0±0.5mm
- PACKAGED IN TAPE AND REEL

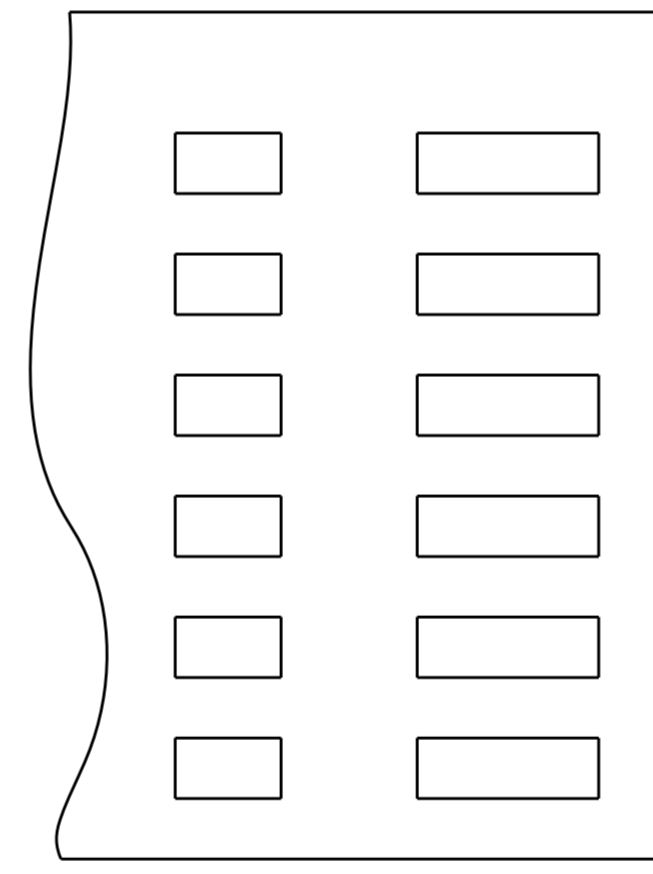
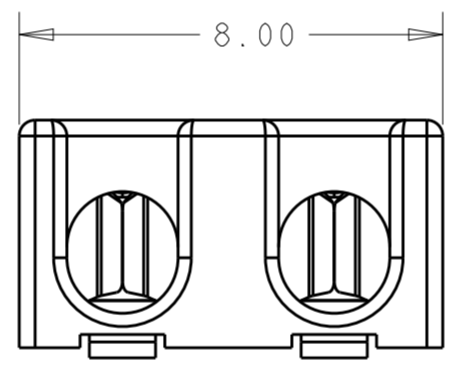
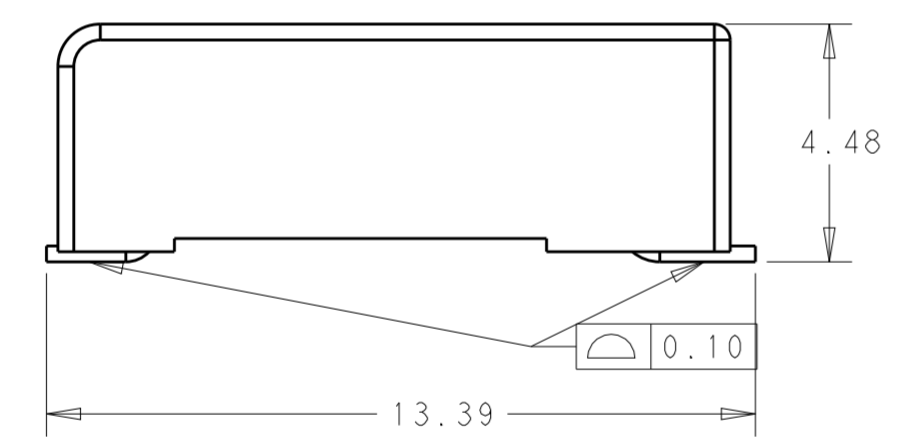
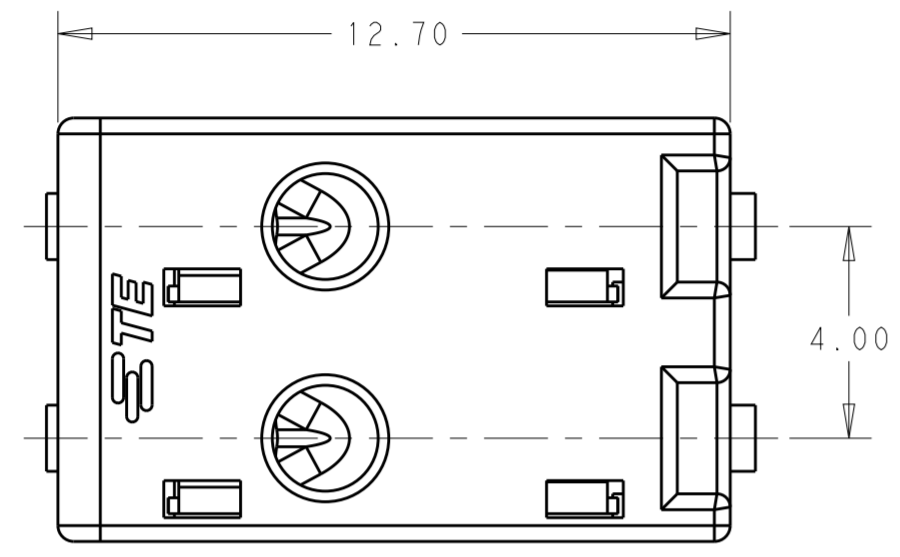

SCALE 4:1

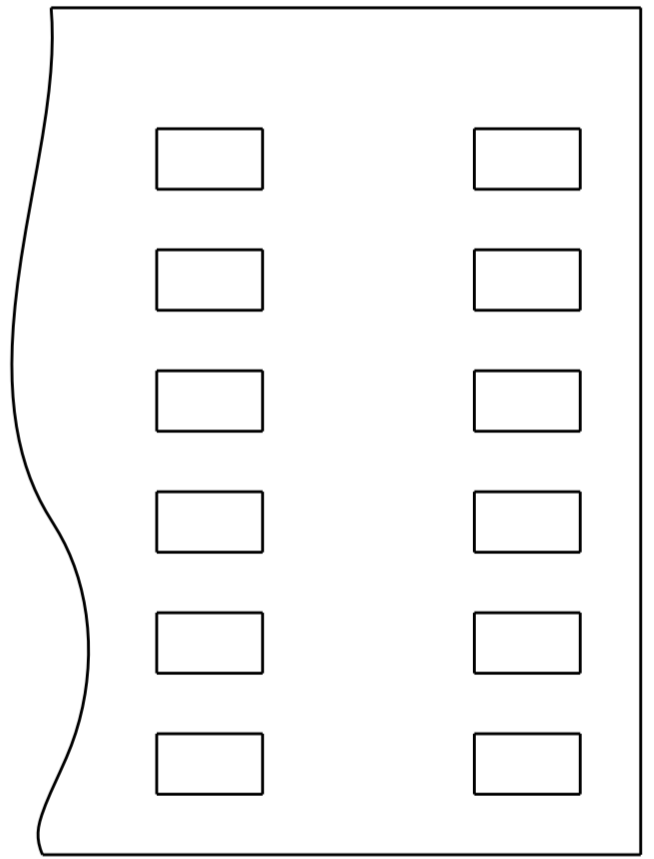

SCALE 4:1

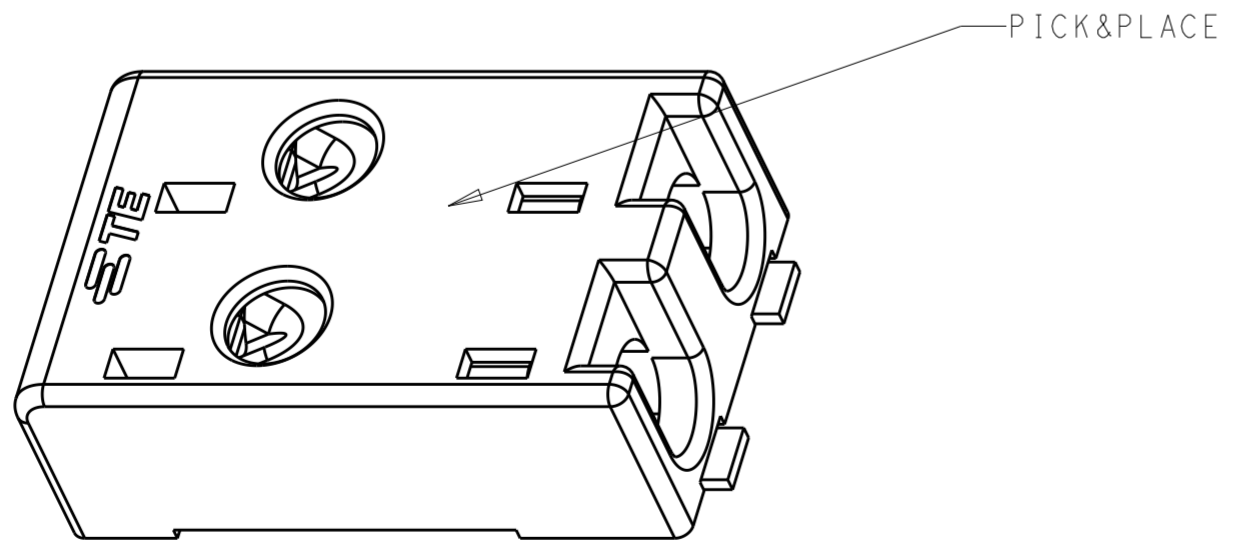

P/N: 2834385-2

THIS DRAWING IS A CONTROLLED DOCUMENT.		DWN 18OCT2018 GEORGE FU	STE TE Connectivity	
DIMENSIONS: mm		CHK 18OCT2018 GEORGE FU		
TOLERANCES UNLESS OTHERWISE SPECIFIED:		APVD 18OCT2018 SHI MING	NAME 2P CONNECTOR ASSEMBLY RELEASABLE POKE-IN	
0 PLC ±-		PRODUCT SPEC 108-137055	SIZE CAGE CODE DRAWING NO RESTRICTED TO	
1 PLC ±0.2		APPLICATION SPEC 114-137055	A200779 C-2834385	
2 PLC ±0.13		WEIGHT -	SCALE 2:1 SHEET 1 OF 1 REV A	
3 PLC ±-		CUSTOMER DRAWING		
4 PLC ±-				
ANGLES ±-				
FINISH SEE NOTE				